

EXAMPLE ALLOTMENT SCHEDULE AND PLAN

Below is an example of a plot schedule. Of course your schedule should reflect what you like to grow - and eat! It should also reflect the time of year. You may hate tomatoes so your Jan to March plan will not include those. You should be thinking ahead and deciding what you would like to grow.

If you have not grown veg before, do look up how to grow the ones you have chosen. Try looking on YouTube or in gardening magazines, books, or by asking other plot holders. Making a monthly 'to do' list like the one below is really helpful even if you change your mind about some of your veg as you go along.

A plot plan is also attached. Drawing out a plan of your plot will help you visualise how it will all fit together. You will be glad that you worked out when things needed to be done (and where) so that you can allocate which bits of your free time needs to be spent on the plot. We know it is not easy to juggle full time work/family etc with keeping a plot well cultivated - organisation is the key!!

First week of October

- Clear plot of any rubbish – metal items to the metal recycling area.
- Build compost bins
- Dig out brambles and perennial weeds

October and November

- Mark out beds
- Dig over plot - bed by bed
- Cover any un-dug beds with cardboard and weed suppressing membrane/tarp

December

- Lay paving slabs for shed base
- Erect shed – Paint shed when weather is dry
- Continue digging – at least 25% of the plot will be dug over by the end of this month
- Decide on what seeds to buy

January, February, March

- Continue digging beds – 50% of beds ready by end of March
- Start chitting potatoes in Feb/March
- Start tomato seedlings
- Pot up dahlias
- Sow onion sets

April

- Start sweetcorn, courgette and pumpkin seeds in pots
- Hoe over dug beds to remove any new weed seedlings as the weather warms up.
- Plant potatoes, direct sow carrots
- Start flower seeds in pots

Etc.....

EXAMPLE ALLOTMENT SCHEDULE AND PLAN

Example of Plot layout

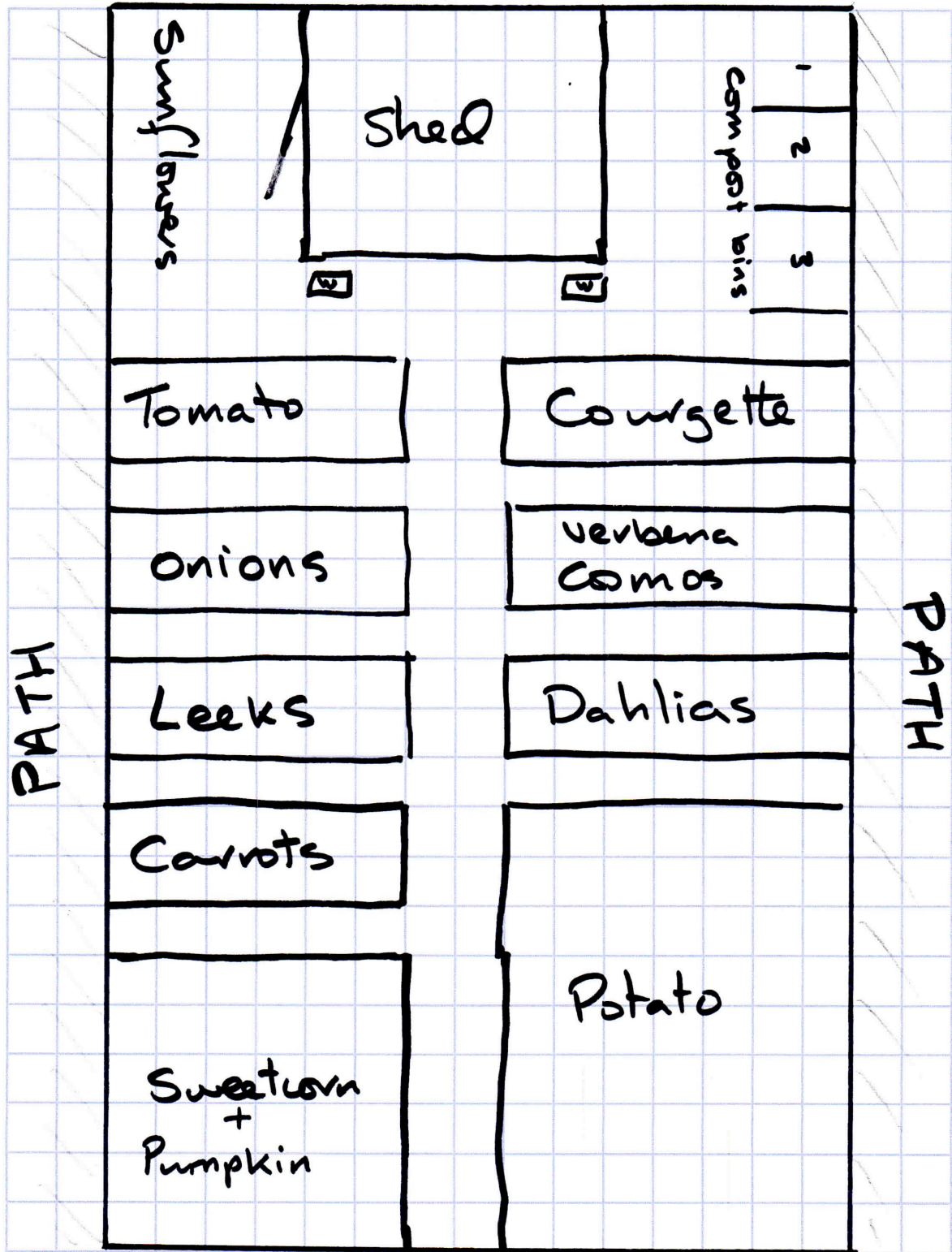

w = water butts